

NAPARA

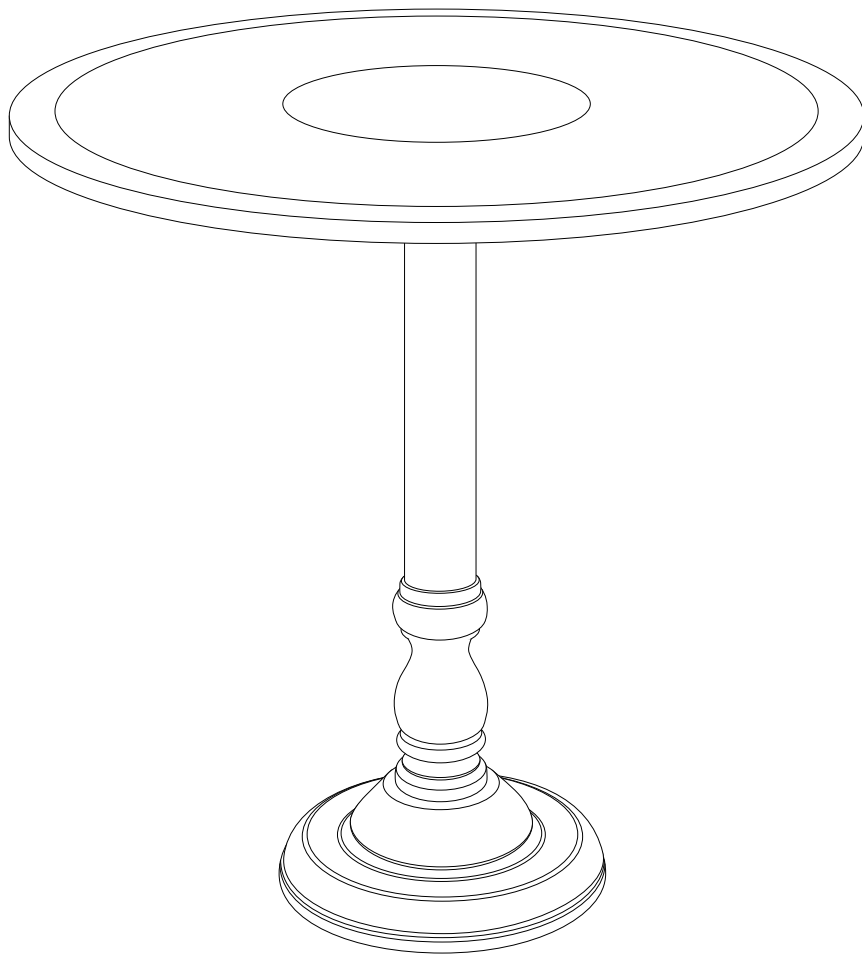

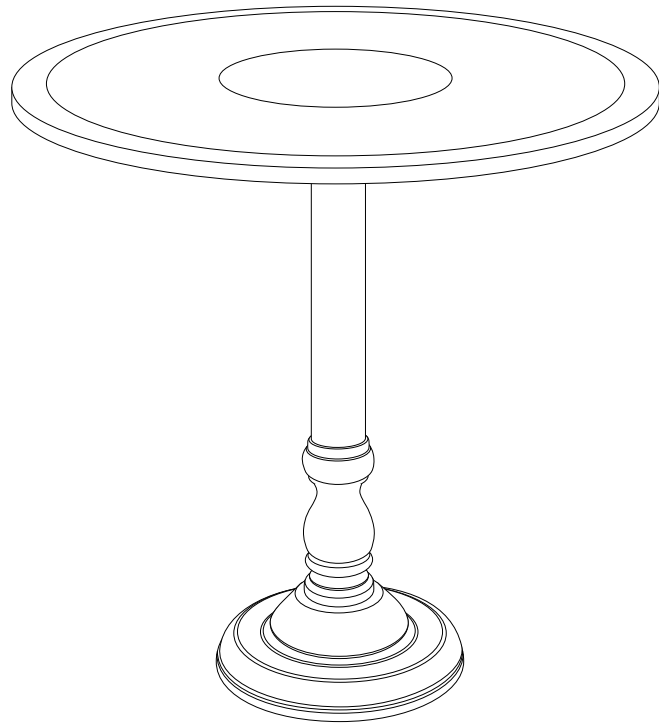
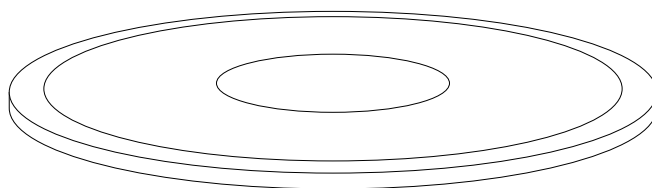

Diagram illustrating safety instructions for assembly:

- Top Box:** Shows a power drill with a diagonal line through it, indicating that power tools should not be used. To the right is a warning triangle with an exclamation mark and a clock icon, with the text "10'" below it, indicating a 10-minute time limit.
- Bottom Box:** Shows a warning triangle with an exclamation mark. To the left, a circular inset shows a block being placed on a mat. To the right, a block is shown with a diagonal line through it, indicating that the block should not be placed directly on a hard surface. Below this is a person icon and the number "1", indicating that one person is required for this step.

A



B



C

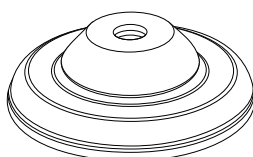

A

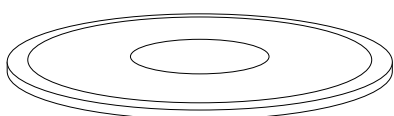

x 1

B



x 1

C

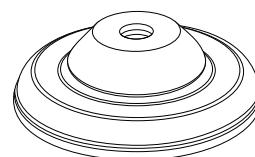

x 1

1

B



x 1

C



x 1

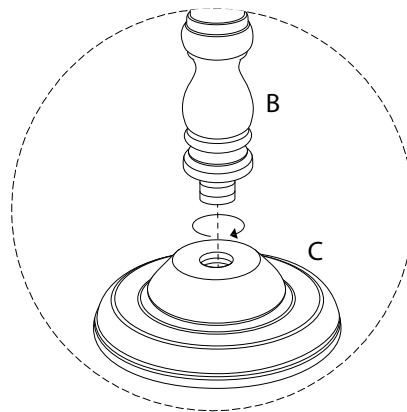
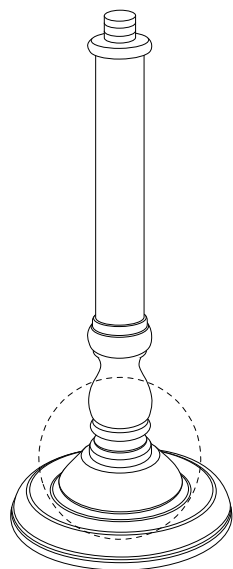

2

A



x 1

